



"innovation in its most functional form"

## PRODUCT DATA SHEET

# SW9™

## MECHANICAL FLANGE

## SPREADER

### SPREADING FORCE:

150 ft/lbs (203 N/m) = 9.4 T (94 kN)

It is recommended that tools are used in pairs giving  
 $2 \times 9.4 = 18.8 \text{ T (188 kN)}$

TOOL WEIGHT = 5.5kg (12.13lbs)

### KIT COMPONENTS

- 1 x SW9™ Wedgehead
  - 1 x 150 ft/lbs (203 N/m) Torque Wrench with 22mm socket
  - 1 x safety block
  - 1 x Instruction Manual
  - 1 x Cardboard Packaging
- Product Code: SW90TMMIN



### WEIGHTS AND DIMENSIONS

|               |                     |                       |  |
|---------------|---------------------|-----------------------|--|
| Tool weight   | = 5.5 kg (12.13 lb) | Packaging Dimensions: |  |
| Torque wrench | = 1.5 kg (3.31 lb)  |                       | 190 x 180 x 320mm (7.48" x 7.09" x 12.60") |
| Safety block  | = 0.5 kg (1.10 lb)  |                       |  |
| Gross Weight  | = 7.5 kg (16.53 lb) |                       |  |

TOOL DIMENSIONS - CLOSED

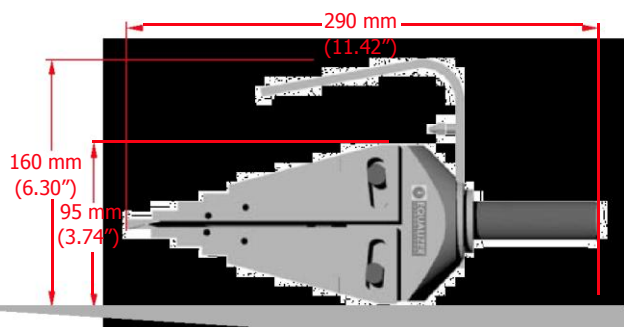

TOOL DIMENSIONS - OPEN

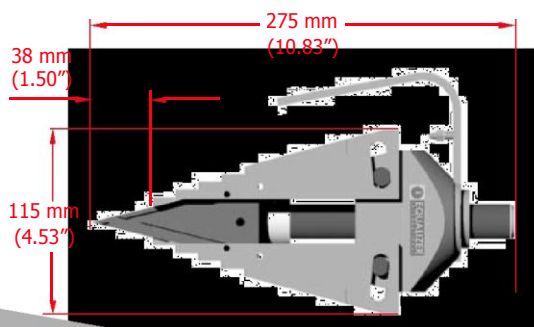

# SW9™

## MECHANICAL FLANGE SPREADER



"innovation in its most functional form"

### TOOL DIMENSIONS - CLOSED

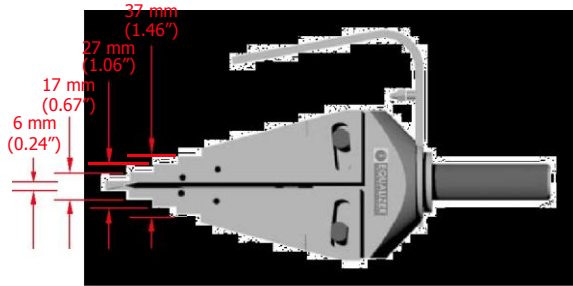

### SAFETY BLOCK

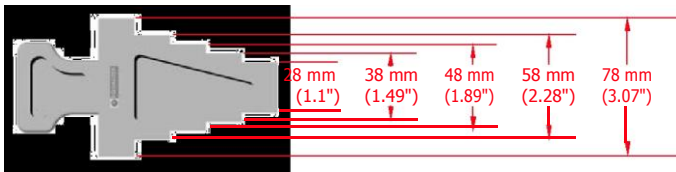

### TOOL DIMENSIONS - OPEN

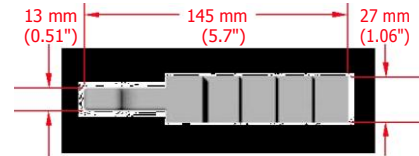
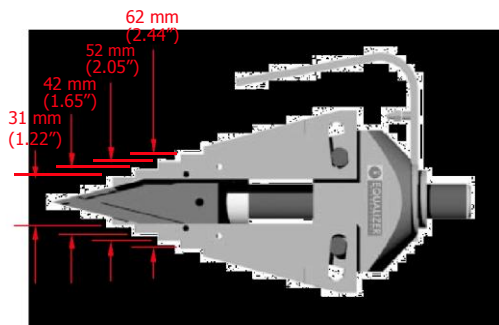

### RANGE OF APPLICATION

All flanges with a minimum access gap of 6 mm (0.24")

### PARTS LIST AND EXPLODED DRAWING

| ITEM | PART No.  | DESCRIPTION            | QUANTITY    |
|------|-----------|------------------------|-------------|
| 01   | 300101-01 | WEDGE                  | 01 each     |
| 02*  | 301502-01 | NUT                    | 01 each     |
| 03*  | 301601-01 | THRUST BEARING SET     | 01 set      |
| 04   | 301802-01 | BEARING HOUSING        | 01 each     |
| 05   | 310601-01 | GREASE NIPPLE          | 01 each     |
| 06   | 301201-08 | ROLL PINS              | 01 set of 8 |
| 07   | 300203-02 | JAWS                   | 01 set of 2 |
| 08   | 312301-01 | HANDLE SLEEVE          | 01 each     |
| 09   | 302202-01 | PUSH-ROD               | 01 each     |
| 10   | 302101-01 | CIRCLIP FOR HANDLE     | 01 each     |
| 11   | 302001-01 | HANDLE                 | 01 each     |
| 12   | 301901-01 | MALE / FEMALE ADAPTOR  | 01 each     |
| 13*  | 300501-04 | SLIDE PINS             | 01 set of 4 |
| 14   | 301102-01 | BODY                   | 01 each     |
| 15*  | 300401-04 | M5 X 6 GRUB SCREWS     | 01 set of 4 |
| 16*  | 301301-01 | M6 X 10 GRUB SCREW     | 01 each     |
| 17   | 634001-01 | TORQUE WRENCH          | 01 each     |
| 18   | 320901-01 | 22mm 1/2" DRIVE SOCKET | 01 each     |

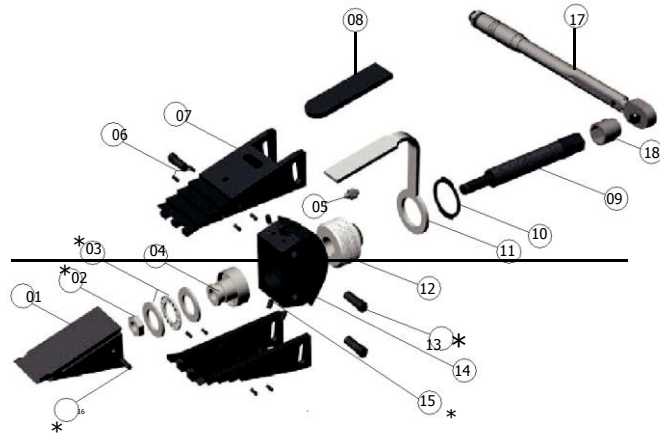

\*Items 02, 03, 13, 15 & 16 are supplied in Repair Kit Part No: 310501-01

### STEPPED BLOCKS

Stepped Blocks can be used singly or in pairs to increase the maximum spreading distance of the SW9™ to 81mm

### STEPPED BLOCK KIT (AVAILABLE AS AN OPTION)

- KIT COMPONENTS**  
 2 x Stepped Blocks  
 2 x M6 x 10 mm Countersunk Screws  
 1 x 4mm Hex Key  
 Kit Part No: 303301-01

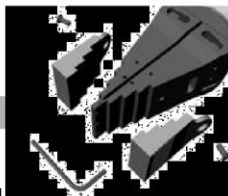

### WEIGHTS AND DIMENSIONS

Stepped Block = 0.52 kg (1.14 lb)  
 GROSS WEIGHT = 1.5 kg (3.5 lb)

